

Safety Instruction

Important Safety Instructions

WARNING

- **TO PREVENT FIRE OR SHOCK HAZARD. DO NOT USE AN EXTENSION CORD.**
- **TO PREVENT FIRE OR SHOCK HAZARD, DO NOT EXPOSE THIS APPLIANCE TO RAIN OR MOISTURE.**
- **TO PREVENT ELECTRIC SHOCK, MATCH WIDE BLADE PLUG TO WIDE SLOT FULLY INSERTED.**



This lightning flash with arrowhead symbol in an equilateral triangle alerts users to presence of un-insulated dangerous voltage within the products enclosure that may be of sufficient magnitude to constitute a risk of electric shock to persons.

CAUTION

**RISK OF ELECTRIC SHOCK
DO NOT OPEN**

WARNING: To reduce the risk of electric shock, do not remove cover (or back). No user serviceable parts inside. Refer servicing to qualified service personnel.



The exclamation mark within an equilateral triangle alerts users to the presence of important operating and maintenance (servicing) instructions in the literature accompanying the appliance.

The appliance should not be exposed to water and no object filled with liquid such as a vase should be placed on the unit.

Important Information

If a television is not positioned in a sufficiently stable location, it can be potentially hazardous if it falls. Many injuries, particularly to children, can be avoided by taking simple precautions such as:

- Using cabinets or stands recommended by the manufacturer of the television.
- Only using furniture that can safely support the television.
- Ensuring the television is not overhanging the edge of the supporting furniture.
- No placing the television on tall furniture (for example, cupboards or bookcases) without anchoring both the furniture and the television to a suitable support.
- Not standing the televisions on cloth or other materials places between the television and supporting furniture.
- Educating children about the dangers of climbing on furniture to reach the television or its controls.
- Figures and illustrations in this user manual are provided for reference only and may differ from actual product appearance. Product design & specification may be changed without notice.

Safety Instruction

1. **Read Instructions** - All the safety and operating instructions should be read before operating.
2. **Retain Instructions** - The safety and operating instructions should be retained for future reference.
3. **Warnings** - All warnings on the appliance and in the operating instructions should be adhered to.
4. **Follow Instructions** - All operating instructions should be followed.
5. **Earthing Connection** - The TV shall be connected to a MAINS socket outlet with a protective earthing connection.
6. **Water and Moisture** - The appliance should not be used near water.
7. **Cart and Stands** - The appliance should only be used with a cart or stand that is recommended by the manufacturer.
8. **Wall or Ceiling Mounting** - The appliance should be mounted to a wall or ceiling only as recommended by the manufacturer.
9. **Ventilation** - The appliance should be well situated so that its location or position does not interfere with its proper ventilation.
10. **Heat** - This appliance should be placed away from heat sources such as radiators, heat registers and stoves.
11. **Power Sources** - The appliance should only be connected to a power supply as described in the operating instructions as marked on the appliance.
12. **Power Cord Protection** - Power supply cord should be routed so that it is not likely to be walked on, pinched by item placed upon it against the cord and its end.
13. **Cleaning** - The appliance should be cleaned only as recommended by the manufacturer.
14. **Power Lines** - An outdoor antenna should be located away from power lines.
15. **Outdoor Antenna Grounding** - If an outside antenna is connected to the receiver, the antenna system must be grounded so as to provide against voltages and built-up static charges.
16. **Non-use Periods** - The power cord of the appliance should be unplugged from the outlet when left unused for a long period of time.
17. **Conditions Requiring Service** - The appliance should be serviced by qualified service personnel when:
 - The power-supply cord or the plug has been damaged.
 - Objects have fallen on or liquid has been spilled into the appliance.
 - The appliance has been exposed to rain.
 - The appliance does not appear to operate normally or exhibits a marked change in performance.
18. This appliance should not be exposed to water and no objects filled with liquids such as a vase should be placed on the unit.



Safety Instruction

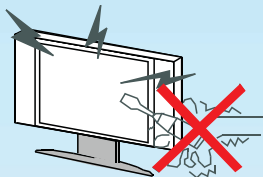

WARNING

High voltages are used in the operation of this product. Do not remove the back cover of the cabinet. Refer servicing to qualified service personnel.

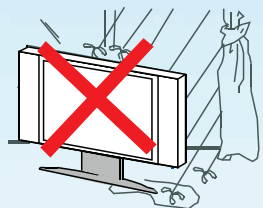

WARNING

To prevent fire or electrical shock hazard, do not expose the main unit to rain or moisture.



WARNING

Do not drop or push objects into the television cabinet slots or openings. Never spill any kind of liquid on the television receiver.

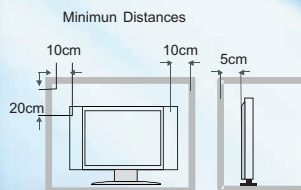

CAUTION

If the television is to be built into a compartment or similarly enclosed. The minimum distances must be maintained. Heat build up can reduce the service life of your television, and can also be dangerous.



CAUTION

Never stand or lean on product or its stand or push suddenly. Always pay special attention when children are near product to avoid harm.



Safety Instruction

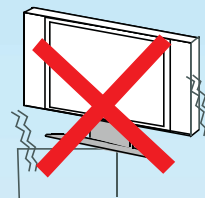

CAUTION

Do not place the main unit on an unstable cart stand, shelf or table.

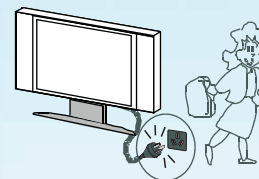

CAUTION

When the product is not used for an extended period of time, it is advisable to disconnect the AC power cord from the AC outlet.



CAUTION

Avoid exposing the main unit to direct sunlight and other sources of heat. Do not position television receiver directly on other products which give off heat. E.g. video cassette players, audio amplifiers. Do not block the ventilation holes in the back cover. Ventilation is essential to prevent electrical failure. Do not squash power supply cord under the main unit.

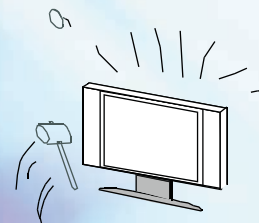

CAUTION

The panel used in this product is made of glass. It can break when the product is dropped or applied with force.



Introduction

Thank you for purchasing this unit. Your unit will bring you years of high-quality viewing enjoyment. The television is easy to operate and provides an exceptionally high quality image. The manual will explain the operation of the unit, including its functions, features and other important features. Before installing or operating your unit, please take the time to thoroughly read this manual, particularly the sections on safety.

Package Contents



1pc Main Unit

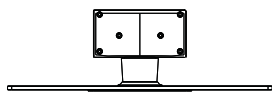

1pc Stand



Screws : 4x12mm BM(x7)

For Model : E42S14A



1pc Main Unit



1pc Stand



Screws : 4x25mm PWA(x7)

For Model : E47S14A and E55S14A



1pc Remote Control



1pc AV Cable



1pc YUV Cable



4pcs 3D Glasses



1pc Remote Receive



1pc Warranty Card

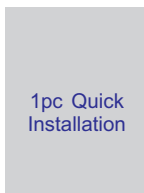

1pc Quick Installation



1pc USB extension cord



1pc USB Cable

Remote Control

Remote Control Key Functions

Power Button
Turns the TV On/Off or to the standby mode.

AUDIO Button
Press to select sound output mode.

MENU Button
Press to enter the main menu.

NAVIGATION/OK Button
Scrolls through menus or options.
OK : Selects menus or options and confirms your input.

EXIT Button
Return back to the previous menu under Smart function. Exit all OSD menu.

3D Button
Press to open 3D setting menu.

+/- Button
To adjust the volume.

ON/OFF Switch
The power of the Remote Control

Indicator 2 : Pairing light/ Low Power Indicator

INDICATOR LIGHT 3
Code sending indicator light.

MUTE Button
Turn on or off the sound.

SUBTITLE Button
Displays your preferred subtitle in DTV mode.

SOURCE Button
Press to display all possible input sources.

INFO Button
Displays the information of the current program.

EPG Button
Open or close EPG menu in DTV mode.

HOME Button
To access the HOME page.

^ / v Button
Scrolls through the saved program.

REC Button
Use to record a program in DTV mode. Press and hold this button for three seconds to display PVR Setting list.

COLOUR FUNCTION Button
To obtain the special functions from certain menus.

MICRO USB PORT
Charging port of remote control.

Indicator 1 : Charging light for Remote Control.

Remote Control for Smart TV

Remote Control for Smart TV

Remote Control



* Remark : Others are Digits, Character, Symbolic Buttons.

Remote Control Function

Remote Control

1. Connect 2.4G QT166 RF Dongle (Support signal reception of 360 degrees) to the USB port on the TV.
2. Turn the power switch to ON from the left side of the Remote Control, the indicator light 3 will flash 3 times, now you can operate the Remote Control.
3. RF Remote Control is supplied with lithium battery.
Please charge in time in case of low battery notifier when you initially use.
4. Plug in USB cable (supplied with the TV) for charging, then connect to the Remote Control/PC/ Adaptor with the current of 5V/1A. Indicator light 1 lights up, when fully charged the indicator light 1 will go out.

Note: Problem occurs and the RF Remote Control does not work or arrow jumping.etc. it may have been interfered by the nearby wireless network. In order to solve this problem, please use the USB extension cord in the packaging to connect the 2.4G QT166 RF Dongle to the TV port, and at the same time keep the 2.4G Qt166 RF Dongle away from the unit without being blocked.



USB extension cord

Left Side of Remote Control Front Panel of Remote Control Right Side of Remote Control



Remote Control Function

RF Remote Control pairing

The Remote Control has been paired completely for your convenience. Users do not need to process this step again under normal condition, but if it does not work with battery fully charged or if you have replaced Remote Control or RF Dongle before operating you should follow the below steps for pairing:

1. Turn on the power at the left side of Remote Control (pairing can be effective in one minute), as RF has low power consumption during pairing, distance must be controlled within half an meter.
2. Press and hold RF Button for 2 seconds, indicator light3 will flash and light up together with indicator light 2.
3. Plug RF Dongle to the USB port on TV/USB port on the computer.
4. Pairing can be finished within 3 minutes, if indicator light 3 and 2 flashes 3 times, that means two devices have been paired successfully. If indicator light lights up all the time or goes out, that means failed pairing. So please unplug the RF Dongle, and repeat the above steps for pairing.



When using the Remote Control, please note:

- Do not strike or drop the Remote.
- Do not expose the Remote Control to liquids and do not place it in humid environments.
- Do not install or place the Remote Control in direct sunlight, the heat may damage the Remote Control.

Main Unit Control

Front Panel

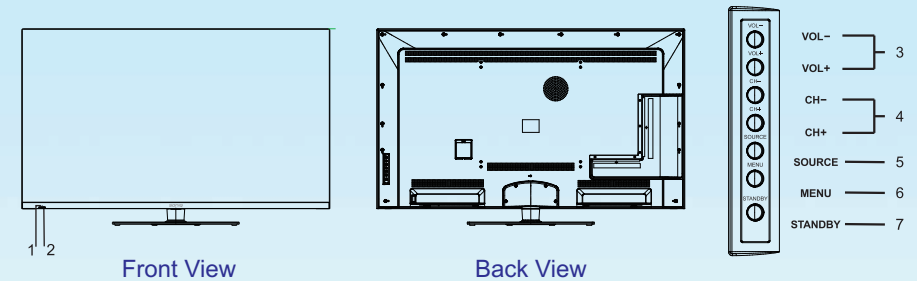

No.	Name	Description
1	Remote Control Sensor Window	Receives the signal from the Remote Control. Do not put any objects in front of the window in order not to hinder the reception of signal.
2	Power Indicator	Flashes red when the unit is powered on: Lights up red when the unit is in standby mode.
3	VOL +/-	Press VOL + to increase volume, or VOL - to decrease. At the OSD menu, press these buttons to move the selection focus left and right to change settings.
4	CH +/-	Press these buttons to sequentially select channels. When the OSD menu is on, press these buttons to move the selection focus up or down to change settings.
5	SOURCE	Press to display all possible input signal sources. Press to cycle through various sources.
6	MENU	Press this button to display the OSD menu. When the OSD menu is on, press this button to exit the menu.
7	STANDBY	Press this button to turn the unit on when it is in standby mode. Press this button once more to put it to standby mode.

Main Unit Control

Rear Panel

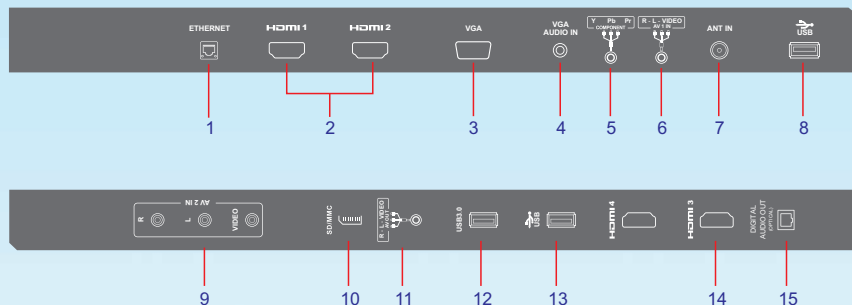

No.	Name	Description
1	ETHERNET	Connect it to the home network.
2	HDMI1/HDMI2	Connect the HDMI cable.
3	VGA	Connect the PC VGA cable of your personal computer.
4	VGA AUDIO IN	DVI or PC VGA audio input.
5	COMPONENT IN	Connect the component video signal.
6	R-L-VIDEO VIDEO 1 IN	Connect the audio and video output of your AV equipment to the unit using the AV cable included in the spare part.
7	ANT IN	Connect to external antenna.
8	USB	Connect USB device, such as USB disk, HID and so on.
9	AV IN	Connect the audio and video output of your AV equipment to the unit.
10	SD/MMC	SD/MMC card reader slot.
11	AV/OUT	Connect the audio and video input of your AV equipment to the unit.
12	USB 3.0	Connect for media files playback and program recording. Not compatible with USB1.1.
13	USB	Connect for media files playback and program recording.
14	HDMI 3	Connect the HDMI signal.
15	DIGITAL AUDIO OUT OPTICAL	Connect the OPTICAL to the Audio Amplifier using an optical cable.

Connection and Setup

Connecting the Power Cord

Connect the power cord directly to the wall outlet.

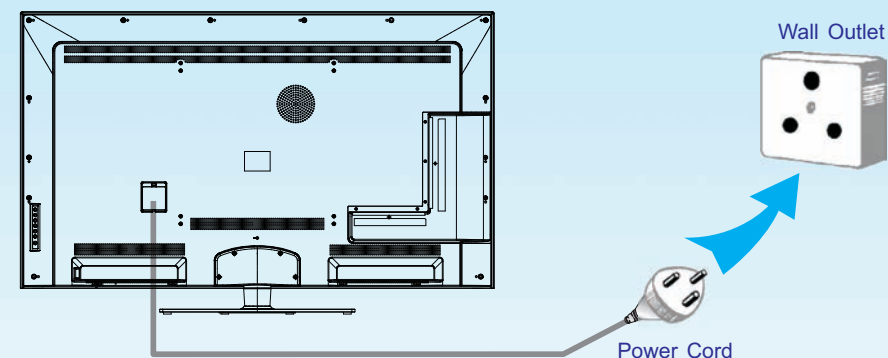

- The product must be operated only from the type of power sources indicated on the marking label (100-240V AC, 50Hz/60Hz.)

If the unit will not be used for a long period of time, it should be unplugged from the wall outlet.

HDMI VGA/PC Connection

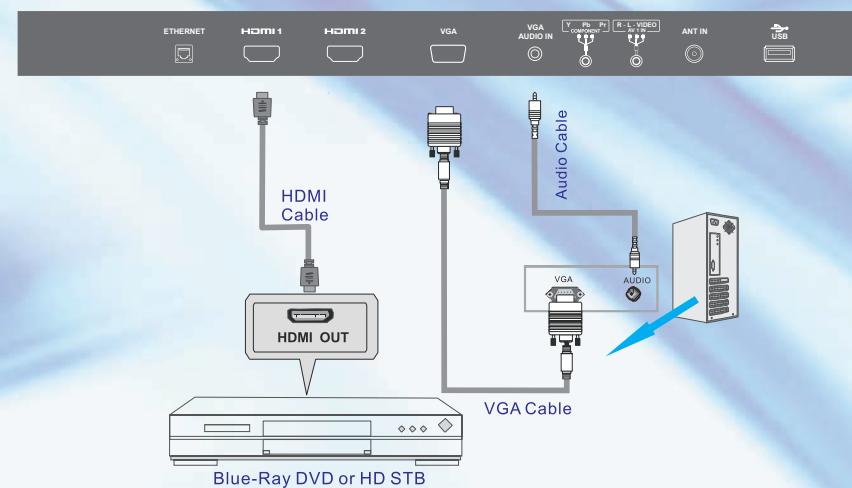

Connection and Setup

Component Connection

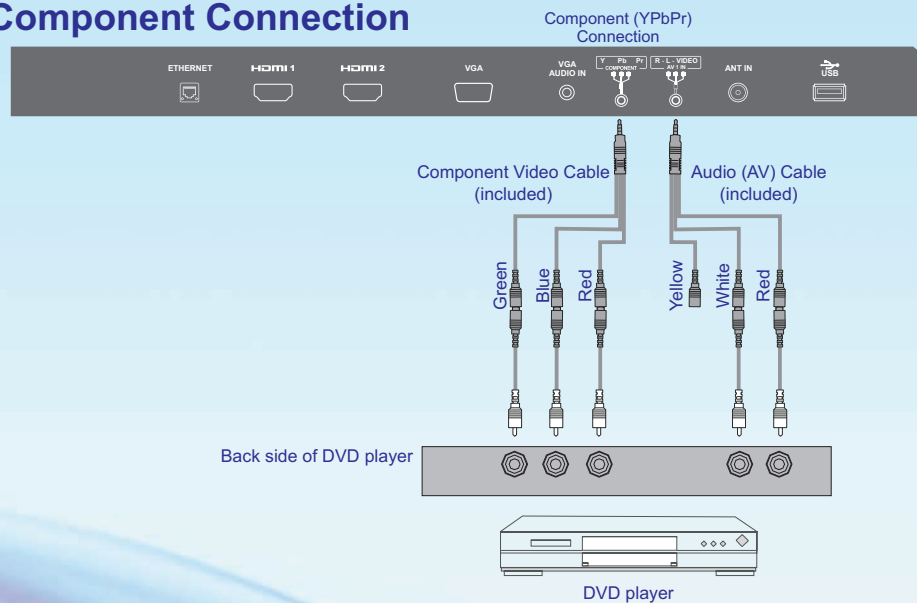

AV IN/OUT Connection

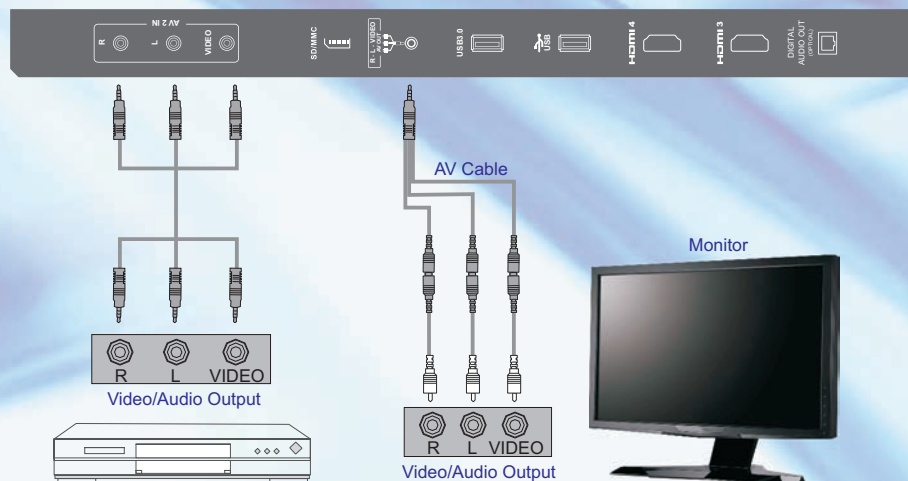

Connection and Setup

Optical Connection

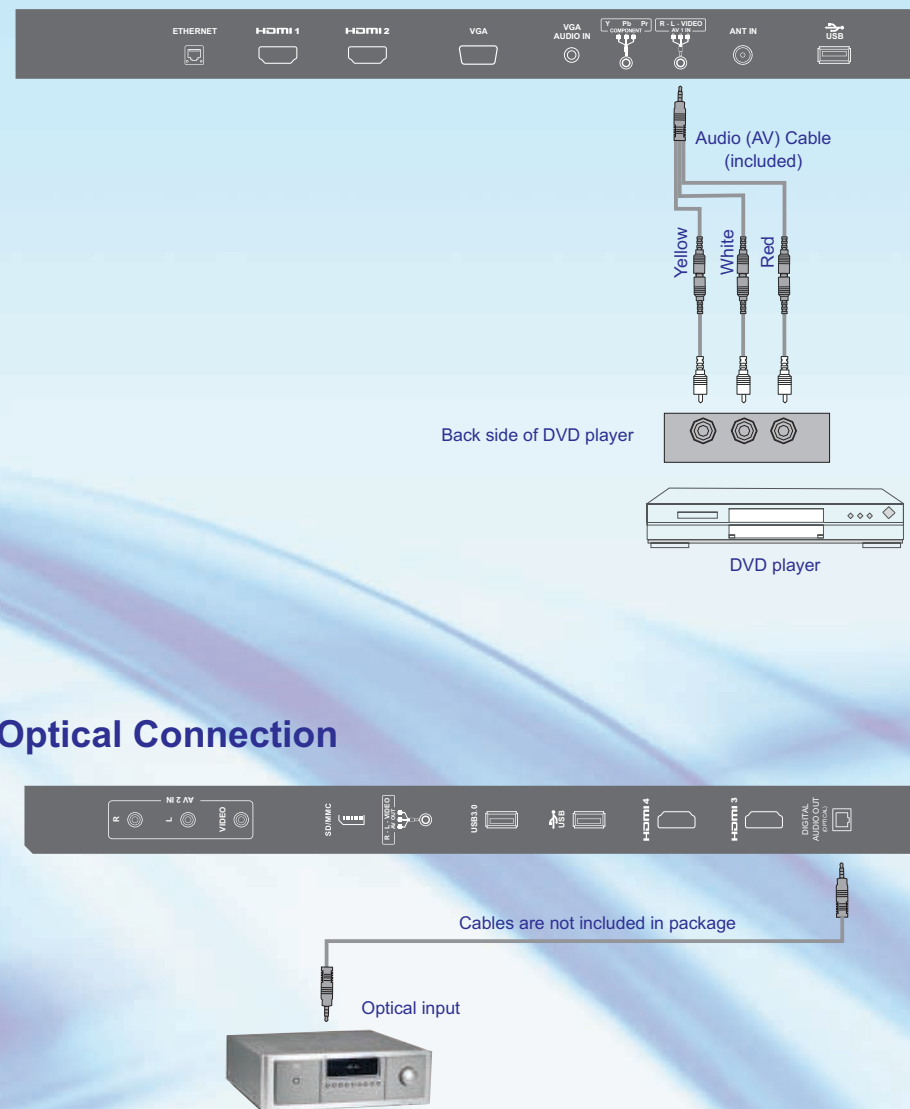

Connection and Setup

ANT IN Connection

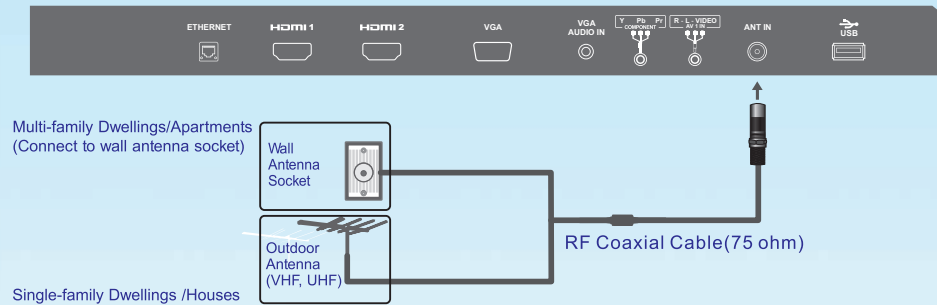

Connecting the USB Device

Insert the USB directly to the unit.

1. Please do not turn off the TV or unplug the USB device when the connected USB storage device is working. When such device is suddenly separated or unplugged, the stored files or the USB storage device may be damaged.



*Remark: The 2.4G USB Device QT166 RF Dongle should be inserted inside the TV before operating.
Don't remove the RF Dongle. Otherwise, the Remote Control cannot be used.*

Connection and Setup

Precautions when using the USB device

1. Please do not turn off the TV or unplug the USB device when the USB is connected. When such device is suddenly separated or unplugged, the stored files or the USB storage device may be damaged.
2. Please use only USB storage devices that are formatted as a FAT32 file system, otherwise it may not be recognized.
3. Every USB port only supply 500mA electric current, if the user's device requirement is over the specification, users need to choose to connect to the external power supply, otherwise the device may not be recognized.
4. If the USB HDD does not have an external power supply, the USB device may not be detected. So be sure to connect the external power supply.
5. The recommended capacity is 2TB or less for a USB external hard disk and 32GB or less for USB flash memory.
6. The recognition speed of a USB storage device may depend on each device.
7. Please connect a USB storage device with the cable offered by the device maker.
8. Be sure to back up important files since data stored in a USB memory device may be damaged. We will not be responsible for any data loss.
9. If your USB memory device has multiple partitions, or if you use a USB multi-card reader, you can use up to 4 partitions or USB memory devices.
10. If the USB memory device does not work properly, disconnect and reconnect it. How fast a USB memory device is detected differs from device to device.
11. If the USB is connected in Standby Mode, specific hard disk will automatically be loaded when the TV is turned on.
12. Any device with more than the recommended capacity may not work properly.

Ethernet/SD/MMC Connection

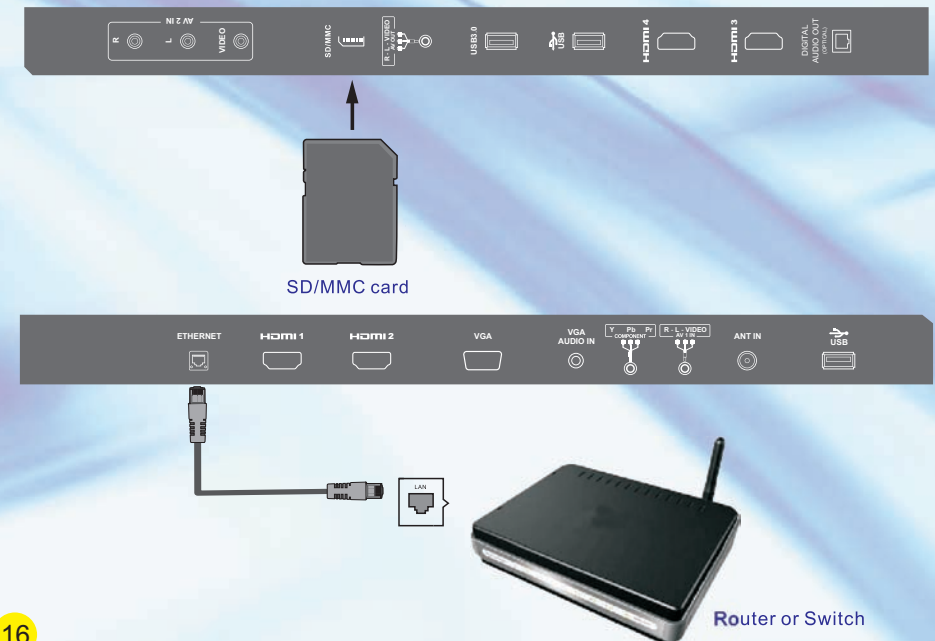

Smart TV Function

Accessing HOME menu

Turning on the TV will automatically enter HOME menu, or you can either press HOME Button to access the HOME menu.

Every time when you enter or return to the HOME page, you will see a “run” key at the bottom right corner of the current functional area which will disappear after flashing for 5 seconds.



No.	Description
1	Member registration and log in
2	Current time and network status
3	Switchover input sources
4	The current playing video or programme
5	Application program section
6	Online shop information release 1
7	Online shop information release 2
8	Favourites
9	Weather

Favourites section operation

Operation for adding application: Select your favourite application from the ALL APPS interface. Press and Hold the Left Return Button on the needed short cut icon for a second to add it to the column.

Operation for deleting this application: Press and Hold the Left Return Button on the icon required to be deleted for a second, the selected one can be deleted.

Smart TV Function

Hot Key operation at HOME page



No.	Description
1	Press HOME Button on the Remote Control to play the current program in full screen/return to the HOME page.
2	Cursor positioning key, which will position at bottom on the first Cinavision.
3	Press Green key to quick select the recent visited application. TV default preferences, can not be covered.
4	Press Yellow Key to view the range of SONIQ Products.
5	Press Blue Key to visit the website of SONIQ.

Smart TV Function

Network Connection

Remark: Network speed requirement is very important to this TV. Please keep network open, if there are any problems with your network connection please contact your internet provider or refer to router manual.

Connecting to wired network

Connect the TV to a local area network (LAN) via the LAN port as shown in the following illustration and set up the network settings.

If wired and wireless networks are both available, wired is the preferred method.

After making a physical connection, a small number of home networks may require the TV network settings to be adjusted.

For most home networks, the TV will connect automatically without any adjustments.

For detailed information, contact your internet provider or refer to router manual.

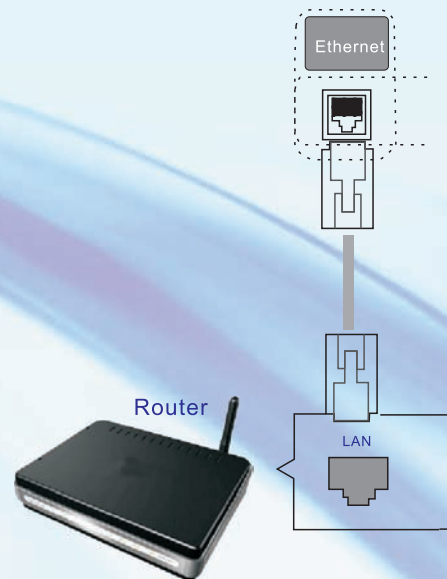

CAUTION

Do not connect a modular phone cable to the LAN port. Since there are various connection methods, please follow the specifications of your telecommunication carrier or internet service provider.

Smart TV Function

The methods of setting up network settings:

HOME -> Settings -> Network and location settings -> Ethernet settings

1. Automatically connect the Ethernet: Ethernet has been confirmed, mark on Obtain IP address automatically, the TV will automatically acquire an IP address to connect to the network.
2. IP Manual Settings: Set the IP address manually, input IP address, Subnet mask, Default Gateway, Primary DNS and Secondary DNS, then press Save to connect the network.

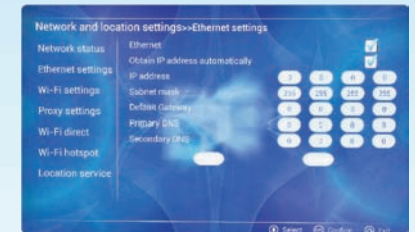

Connect to wireless network

- Setting up the AP (Access Point) or the wireless router is required before connecting the TV to the network.
- The network configuration and connection method may vary depending on the equipment in use and the network environment. Refer to the setup instructions supplied with your access point or wireless router for detailed connection steps and network settings.



The methods of setting up wireless connection:

HOME -> Settings -> Network and location settings -> Wi-Fi direct

1. Select Wi-Fi, then the system will automatically scan all the AP and wireless routers within the scope and then display the device list.
2. Select an AP and wireless router and input the password for saving, then the network can be available.
3. This TV includes wireless mode and has wi-fi function.

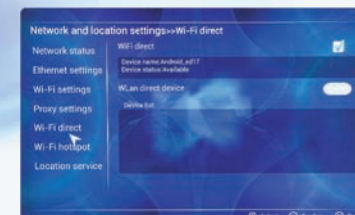

Smart TV Function

Tips for Network Settings

- Use a standard LAN cable with a connector.
- Many network connection problems during set up can often be fixed by re-setting the router or modem. After connection to the home network, quickly power off and / or disconnect the power cable of the home network router or cable modem. Then power on and / or connect the power cable again.
- Depending on the internet service provider (ISP), the number of devices that can receive internet service may be limited by the applicable terms of service. For details, contact your ISP.
- We are not responsible for any malfunction of the TV and / or the internet connection feature due to communication errors / malfunctions associated with your broadband internet connection, or other connected equipment.
- We are not responsible for problems within your internet connection.
- Some content available through the network connection may not be compatible with the TV.
- You may experience undesired results if the network connection speed does not meet the requirements of the content being accessed.
- Some internet connection operations may not be possible due to certain restrictions set by the internet service provider (ISP) supplying your broadband internet connection.
- A 10 Base-T or 100 Base-TX LAN port is required when using a wired connection to this TV. If your internet service does not allow for such a connection, you will not be able to connect the TV.
- ADSL modem is required to use DSL service and a cable modem is required to use cable modem service. Depending on the access method of and subscriber agreement with your ISP, you may not be able to use the internet connection feature contained in the TV or you may be limited to the number of devices you can connect at the same time. (If your ISP limits sub-scription to one device, this TV may not be allowed to connect when a PC is already connected.)
- The wireless network operates at 2.4GHz radio frequencies that are also used by other household devices such as cordless telephone, Bluetooth devices, microwave oven, and can be affected by interference from them.
- It may reduce the service speed using wireless network by surrounding wireless condition.
- Turn off all unused network equipment in your local home network. Some devices may generate network traffic.
- In some instances, placing the wireless router or access point higher up away from the floor may improve the reception.
- The reception quality over wireless depends on many factors such as type of the access point, distance between the TV and access point, and the location of the TV.
- To connect wireless AP, and AP that supports the wireless connection is necessary, and the wireless connection.

Smart TV Function

- Function of the AP needs to be activated. Please enquire to the AP supplier for the possibility of AP wireless connections.
- Please verify the security settings of AP SSID for wireless AP connection, and enquire to the AP supplier for the AP SSID security settings.
- The TV can become slower or malfunction with wrong settings of network equipments (wired / wireless router, hub, etc). Please install correctly by referring to the manual of the equipment, and set the network.
- When AP is set it include 802. 11n, and if Encryption is designated as WEP or WPA(TKIP / AES) and WPA2 hardware encryption schemes, the connection may not be possible. There may be different connection methods according to the AP manufactures.

Wi-Fi Direct

HOME - > Settings - > Network and location settings - > Wi-Fi direct

The connected device must acquire the Wi-Fi Direct certificate.

Wi-Fi Direct can at any time realize interconnection without the help of Wi-Fi router and AP.

1. Make sure the Wi-Fi Direct is enabled both on TV and the connected device.
2. Enable the Wi-Fi Direct at the connected device.
3. The devices which are available for TV connection display in the window list.
4. Select the device you are willing to connect to the TV then choose YES if connecting request appears.
5. If the connected device accepts the request, then the connecting setup has been done.

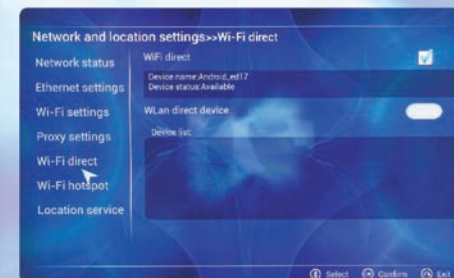

Smart TV Function

Wi-Fi Hotspot

HOME - > Settings - > Network and location settings - > Wi-Fi hotspot
First, assure TV is connected to wired network. Then to get mobile phone or notebook connected to TV. Specific operations are as follows:

1. Make sure the Wi-Fi hotspot on TV is enabled.
2. Select settings to input the SSID and password. Choose Save to complete the settings.
3. Use mobile phone and notebook to search TV Wi-Fi hotspot, and then input the password.
Connection has been completed.



Note: Should you change the password, the modified password should contain at least 8 characters.

ALL Apps

Press the NAVIGATION Buttons to scroll to the ALL Apps and press OK, from the displayed window you can operate any of the downloaded apps.

Application Management

Please insert the SD card before applying this function.

Apps Installation:

Install the apps that you want from the on-line shop.

1. The procedure for registration on cinavision are as follows:
 - 1.1 Click on the login at the top of the HOME page.
 - 1.2 Select register and obey the clause.
 - 1.3 Input the user name, e-mail and password, then confirm the password.
 - 1.4 Registration completed after being confirmed.



Smart TV Function

2. Click on the Login at the top of the HOME page, input e-mail and password to log in to visit the on-line shop.
On-line apps can be downloaded through HOME - > Market - > Apps
 - 2.1 Choose the application that you need from the list.
 - 2.2 Check the related information about the application, select install.
 - 2.3 The installed application will display at interface of ALL Apps, click one of them for running.
 - 2.4 If there is not enough space on the TV you can download the application into the SD card for running.

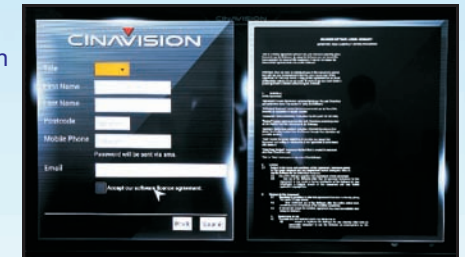

Application Uninstall / Move

1. Find the application that you want to uninstall or move through the method of HOME - > Settings - > Application management - > All applications
System provided application can not be uninstalled.
2. Open the application, then select Uninstall / Move.



Environment Selection

Initial setup window will appear when you first start to use, choose the setting mode you want.

You can either choose to select HOME USE or DEMO.

HOME USE: To use this TV at home without demonstrating any advertisements.

DEMO: To use this TV for in-store demonstration with digital adverts. (Please do not select this mode when using at home.)

Users can switch between these two modes by following the below method. Press HOME Button to enter the HOME menu, click on Settings will pop up to System settings, go to Environment selection from the displayed window, you can cycle through the two different mode by pressing Up and Down Button, then press OK Button to confirm.

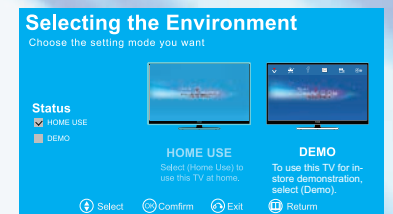

Smart TV Function



Note: When DEMO Mode is executed, please first press EXIT Button to exit then follow the above operation by going to Settings then enter Environment selection for closing.

File Explorer

To enter File Explorer interface by HOME -> All Apps -> File Explorer

1. Click on the Menu Icon at the top right of the screen or MENU Button on the Remote Control to display the edit menu; then continue with the related operation.

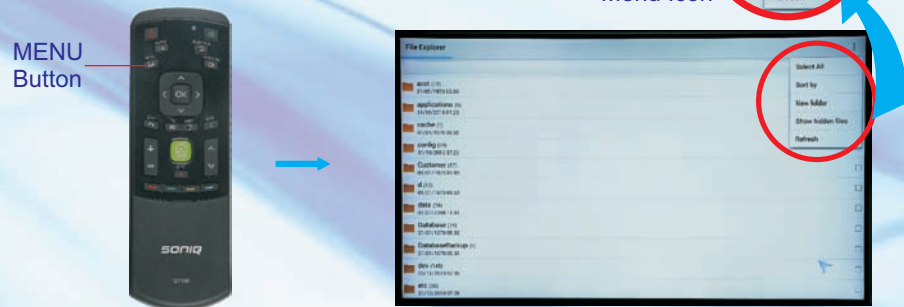

2. Select a file, then press and hold the LEFT MOUSE Button or "OK" Button for 2 seconds to have related operation on the selected file.



Smart TV Function

Browser

To open Browser click on HOME -> Browser

Website can be entered by (keyboard on the Remote Control / keyboard on the TV screen / external keyboard), you can view the website on the TV.

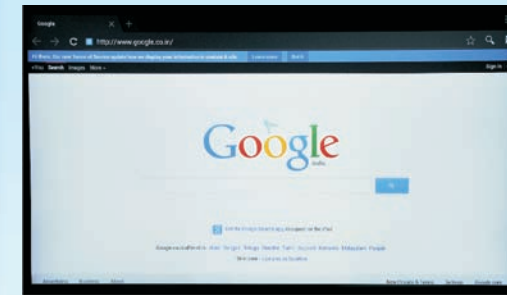

Add the Bookmark

Click on the (Star Icon) at the top right of the page to display a page, from which you can add bookmarks, view visited history.

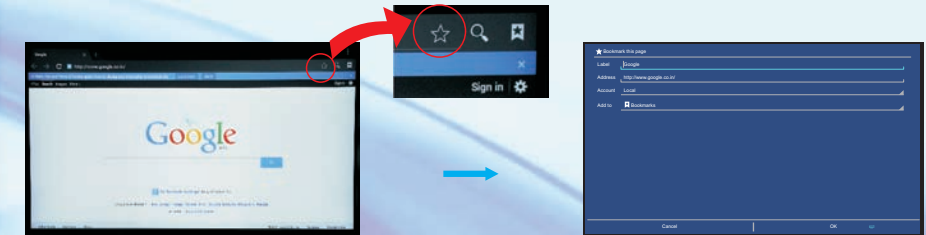

Media:

This function can allow you to view the shared media from the memory storage.

Note: Before operating Media function, plug in USB device.

HOME -> Media

Press Navigation Button to view the shared media in the category.



Smart TV Function

Press OK Button to play or Exit to exit



No.	Description
1	Skip to the previous picture.
2	Click it to play or pause playback.
3	Skip to the next picture.
4	Zoom in the picture.
5	Zoom out the picture.
6	Right rotation.
7	Left rotation.
8	Display the information of the picture.
9	Set the picture as a wallpaper.
10	Set the animation effect and interval time of playing the picture.

Smart TV Function

Music Playback

Enter this function by HOME -> Media, then select your favourite song for playing. Press OK to play the music and Exit to exit playback.

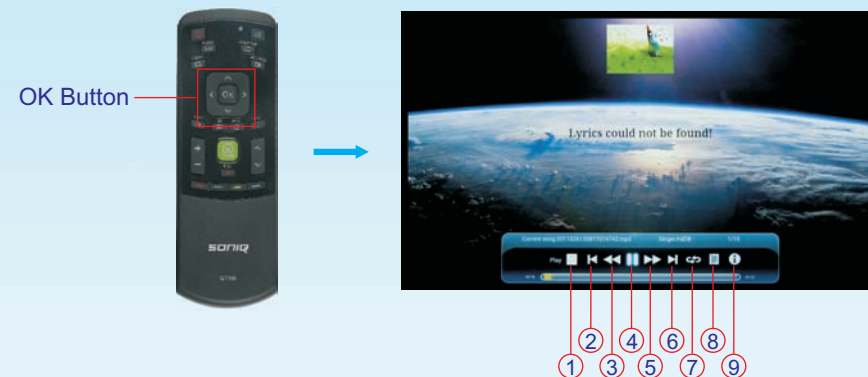

No.	Description
1	Stop video playback.
2	Play the previous video.
3	Fast rewind playback.
4	Playback or pause.
5	Fast forward playback.
6	Play the next one.
7	Press to switch among single playback/random playback/cycle playback.
8	Display all the songs added to the play list.
9	Display the information of the current playing song.

Smart TV Function

Video Playback

Enter this function by HOME -> Media, then select your favourite video for playing. Press OK to play the video or Exit to exit.

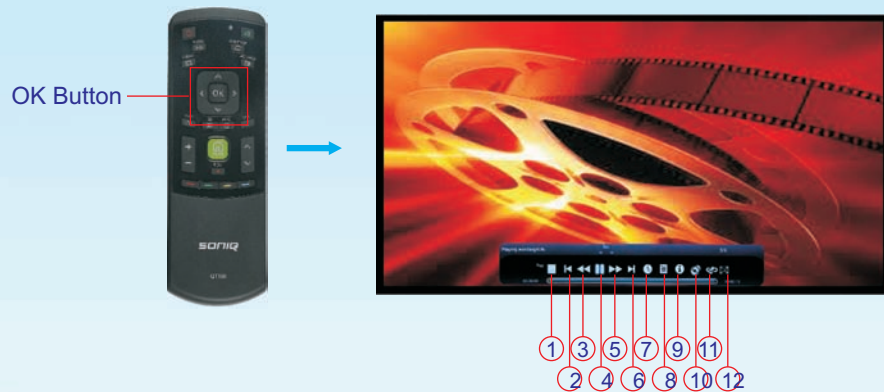

No.	Description
1	Stop video playback.
2	Skip to the previous video.
3	Fast rewind playback.
4	Playback or pause.
5	Fast forward playback.
6	Skip to the next video.
7	Time setting : Display the time progress of the current video playback, or set the video cut-in time.
8	Display all the videos.
9	Display the information of the current video playback.
10	Playback setting including subtitle, breakpoint and audio track setting.
11	A-B cycle playback.
12	Zoom in or zoom out of the video picture.

Smart TV Function

System Update

In order to enhance the network quality of the TV, regularly update the software from official website.

Auto network updating

Turning on the TV will automatically detect the software package, you can click on Download to download the new software, or click the RIGHT MOUSE Button or EXIT Button on the Remote to exit the network update.

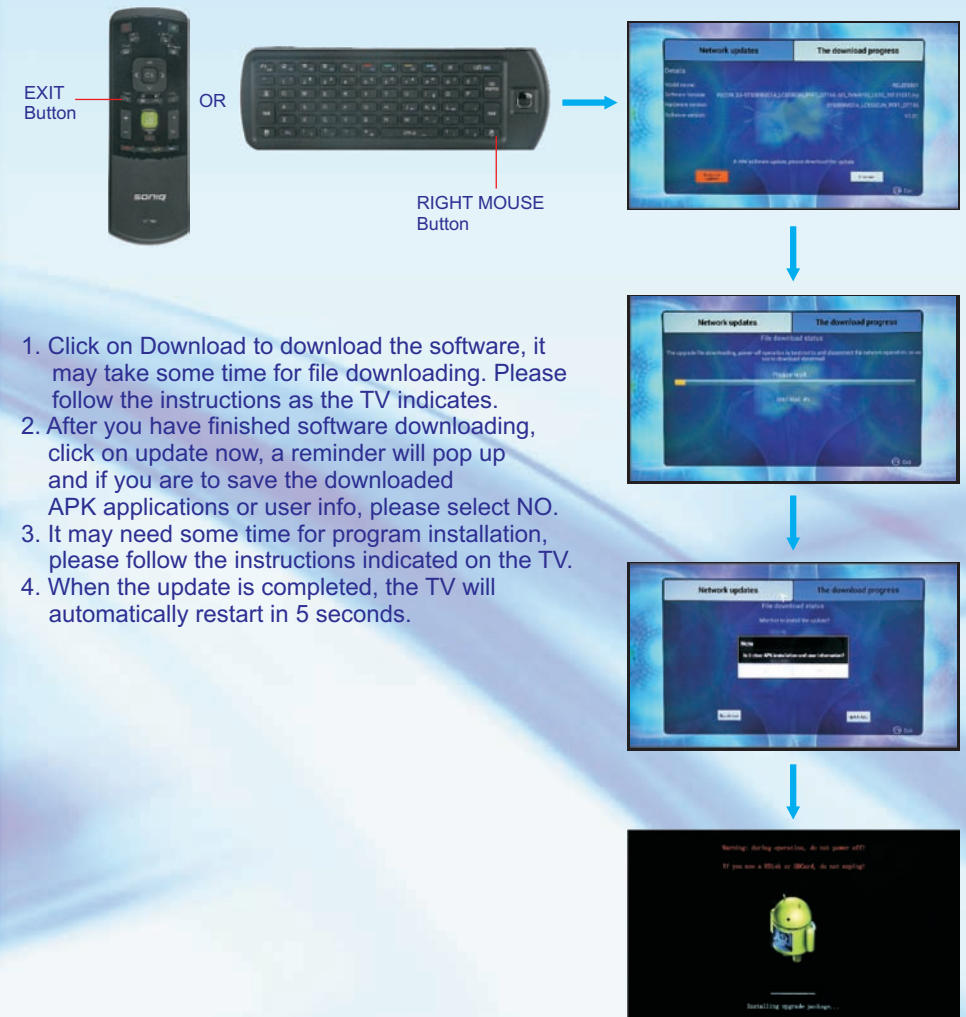

1. Click on Download to download the software, it may take some time for file downloading. Please follow the instructions as the TV indicates.
2. After you have finished software downloading, click on update now, a reminder will pop up and if you are to save the downloaded APK applications or user info, please select NO.
3. It may need some time for program installation, please follow the instructions indicated on the TV.
4. When the update is completed, the TV will automatically restart in 5 seconds.

Smart TV Function

Manual Network update

HOME -> Settings -> System update or restore Factory -> System local update -> Network Update to enter the interface of network update, then follow the steps of auto network updating as above.

Local Update

1. Users need to download the related new software from our official website.
2. Copy the software update to the USB device, and named after update signed. zip
3. HOME -> Settings -> System update or restore Factory -> System Update -> Local Update to enter the interface of local update, click on Update immediately to start local update.



OSD Menu Operation (Before operating OSD menu, Please switch to full screen playback by pressing HOME Button on the remote).

OSD menu can only be operated by using remote control.

Press MENU Button to enter the main menu, use Left and Right Button to select CHANNEL.



Auto Tuning

1. Auto Tuning will be highlighted upon displaying this menu. Press OK Button to enter.
2. Press ◀/▶ to select country, press OK Button to enter the next step.
3. Use ▲/▼ button to select your location, then press OK button to enter the next step.
4. Press Up and Down to select tuning type. Press OK to start auto search.



Smart TV Function

ATV Manual Tuning



Press Up and Down Button to highlight ATV Manual Tuning, then press OK to enter sub-menu.

1. **Analog Scan** : Press "OK" and then adjust Analog Scan by pressing Left and Right Button.
2. **Sound System** : Press Left and Right Button to change (left/right/up/down) it into DK or BG mode.
3. **Search** : Press Left and Right Button to set the Frequency and stop it by pressing OK, Left and Right Button.
4. **Frequency** : Display the adjusted frequency channel.
5. **Fine Tune** : Press Left or Right Button to make minor modulation and stop it by pressing OK, Left and Right Button.

Program Edit

Press Up and Down to select Channel Edit, then press OK Button to enter sub-menu.

1. Press Green Button to rename the current channel. (only available in ATV)
2. Press Yellow Button to change the program order.
Selected channel can be moved by using Up and Down, then press OK for confirm.
3. Press Blue Button to skip the selected channel.
4. Press Red Button to delete the selected channel.



Smart TV Function

Picture Menu

Press MENU Button to bring up the main menu, then press Left and Right to select the PICTURE MENU.

1. Picture Mode:

Press Left and Right to adjust the mode colour by Standard, Dynamic, User, Mild and 3D Mode. Contrast, Brightness, Color, Sharpness can be adjusted only under User mode, press MENU to return to the main menu.

2. 3D Settings:

Once the TV receives 3D signal, the system will automatically turn this function On. To watch in 3D, you are required to wear 3D glasses. Use Up and Down Button to select On or Off, press OK to confirm, EXIT to quit.

3. Noise Reduction:

Press OK Button to adjust among Strong, Weak, Middle and Off.

4. Colour Temp:

Press Left and Right Button to select Cool, Standard, Warm and User. You can adjust R Gain, G Gain, and B Gain in User mode.

5. Energy Saving

Press OK Button to adjust among Middle, High, Low, Standard in this section.

6. Aspect Ratio:

This function will be available under VGA or HDMI, and you can choose Full, 4:3 and Auto by pressing Left and Right Button.

7. Screen Mode (available under VGA or HDMI)

Press Up and Down to choose Screen Mode, press OK to confirm. Press Left and Right to select PC/Video.

8. PC Settings (available under VGA or HDMI)

Press Up and Down to select PC Settings, press OK to enter the sub-menu, you can also choose auto adjust to adjust the picture to full screen, or you can select clock, phase, horizontal position, vertical position for adjusting.



Smart TV Function

Sound Menu

Press MENU Button to display the main menu.

Press Left and Right to enter the SOUND page, it will highlight the first option, then press OK Button to enter the sub-menu.

1. Sound Mode:

Press OK and then press Left and Right to adjust Sound Mode. You can change the value of Treble and Bass under user mode.

2. Balance:

Press Up and Down to select Balance, then press OK Button to enter sub-menu, press Left and Right adjust.

3. Auto Volume (AVC):

Press Up and Down to select Auto Volume, then press OK and Left and Right to select On or Off.

4. SPDIF Mode:

Press Up and Down to select SPDIF Mode, then press OK and Left and Right Button to select PCM, Off or Bitstream.

5. Power On Music:

Press Left and Right Button to set On or Off.



Smart TV Function

Time Menu

Press MENU Button to display the main menu.

Use Up and Down to enter TIME page, it will highlight the first option.

1. Current Time:

Can not be selected, but it can automatically obtain the network time.

2. Off Time:

Press Up and Down to select Off time, the press OK Button to enter the sub-menu, press OK and adjust it into On or Off.

3. On Time:

Press Up and Down to select On Time, then press OK Button to enter the sub-menu, press OK to proceed with the On and Off time settings.

4. Sleep Timer:

Press Up and Down Button to select Sleep Timer, then press OK to confirm, press Left and Right to adjust.

5. Time Zone:

you can choose different location by operating this item.



Option Menu

Press MENU Button to display the main menu.

Press Left and Right to enter OPTION page, it will highlight the first option.

1. OSD Time Out:

Press OK and then press Left and Right Button to set the OSD Time Out.

2. PVR Settings:

Press OK button to display the related functions included in this item.

3. Restore Default:

Operate this item to resume all the initial settings.



Smart TV Function

Lock Menu

Press MENU Button to bring up the OSD menu.

Use Left and Right to turn to LOCK page (this function is only available under TV mode), it will highlight the first option, then you are required to input the password (default as 0000).

1. System Lock:

Press OK to select On or Off.

2. Channel Lock:

Press Up and Down to select Channel Lock, then press OK to enter the sub-menu, press Up and Down to select the program that you want to lock, then press OK to confirm.

3. Parental Guidance:

Parent can set age limit level by this function.

4. Set Password

Press Up and Down to select Set Password, press OK Button to enter the sub-menu to set the new password.



PVR Function PVR Settings

(This feature is only available under DTV mode.)

Please plug in the USB device before executing recording function and as well do the following settings to save the file recording.

1. MENU->OPTION MENU->PVR SETTINGS->DEVICE LIST

2. Select a USB storage device formatted as FAT, press OK to confirm.

3. If a USB storage device formatted as a different format, press the red button on the remote to format as FAT, recording can be carried out by this time. EXFAT is not supported by the system, format of NTFS is just available for reading, and can not be applied for recording.

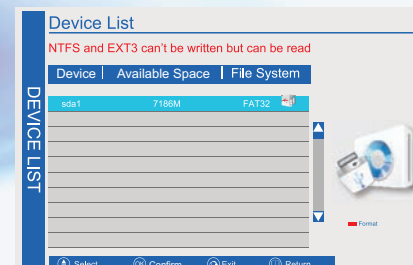

OSD Menu Operation

Precautions when using the USB device

1. Please do not turn off the TV or unplug the USB device when the connected USB storage device is working.
When such device is suddenly separated or unplugged, the stored files or the USB storage device may be damaged.
2. Please use only USB storage devices that are formatted as a FAT32 file system, otherwise it may not be recognized.
3. Every USB only supplies 500mA electric current, if the user's device requirement is over the specification, users need to choose to connect to the external power supply, otherwise the device may not be recognized.
4. If the USB HDD does not have an external power supply, the USB device may not be detected. So be sure to connect the external power supply.
5. The recommended capacity is 2TB or less for a USB external hard disk and 32GB or less for USB flash memory.
6. The recognition speed of a USB storage device may depend on each device.
7. Please connect a USB storage device with the cable offered by the device maker.
8. Be sure to back up important files since data stored in a USB memory device may be damaged. We will not be responsible for any data loss.
9. If your USB memory device has multiple partitions, of if you use a USB multi-card reader, you can use up to 4 partitions or USB memory devices.
10. If the USB memory device does not work properly, disconnect and reconnect it. How fast a USB memory device is detected differs from device to device.
11. If the USB is connected in Standby Mode, specific hard disk will automatically be loaded when the TV is turned on.
12. Any device with more than the recommended capacity may not work properly.

In-Time Record

You can record the program you are watching. Press REC on the remote to start the recording. Recording icon and recording time will be displayed at the right bottom of the Screen.

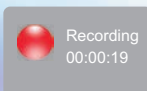

OSD Menu Operation

Stop Record



1. Press STOP button to stop the recording.
2. Press Navigation buttons to scroll to Yes, and press OK button.

Pre-record

1. Press EPG on the remote to open the program guide, select the program that you want to record, then long press REC for three seconds to add the program to Pre-record list.
2. Press the green button on the remote to delete the selected recording group, yellow button to delete all the recording group.
3. You can also enter PVR settings by the method of :MENU->OPTION MENU->PVR SETTING->SCHEDULED RECORD SETTING LIST. Select a blank recording group, then press OK to enter the setting list to set the recording task.

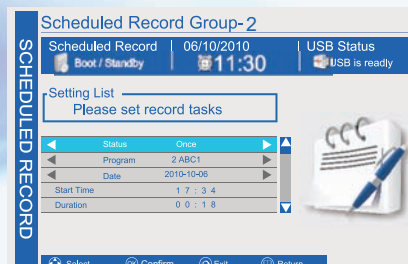
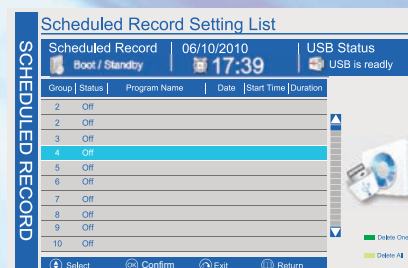

OSD Menu Operation

Play the recorded program

1. MENU->OPTION MENU->PVR SETTINGS->FILE MANAGER



2. Select the recorded program that you want to play, press OK button or red button to play the program at the left window.
Press the blue button to play in full screen, press it again to exit the full screen playback.
Press green button to delete the selected recorded program.
Press yellow button to delete all the recorded programs.
3. The current program and device information will be displayed underneath the played program.

EPG

Press EPG to show the EPG list.

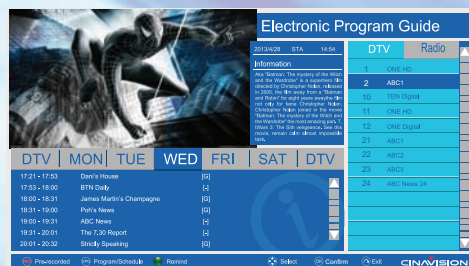

Channel list ,program information and progress list can be carried out by operating this function. The EPG displays the program details for next 7 days, you can choose the program that you want to have pre-record, press REC to have program pre-record.

3D Image

3D Image

- When watching 3D images, Please wear 3D glasses.
- As the TV turns on, it may take seconds until the picture quality is optimized.
- The 3D passive glasses may not work properly if there is any other objects standing between the TV set and 3D glasses.
- Note that when your eyes are away and then back to the 3D images, a short time will be needed for your eyes to get adapted.
- When watching 2D images, we recommend removing 3D glasses. If you wear 3D glasses to watch 2D images, the picture will be distorted.

Safety Information for Watching 3D Images

You may not feel the 3D effect if your viewing angel and distance between the TV and glasses are out of range.

- * 3D effect may not be available if the receiving area is out of range.
- * Do not watch 3D pictures for a long period of time for your health.
- * Note that watching TV with 3D glasses for an extended period of time may cause drowsiness and eye strain.
 - If you experience any of the symptoms of headache, fatigue, dizziness, sickness, convulsions, loss of awareness, confusion, immediately stop watching 3D TV and consult a medical specialist.
- * The pregnant, elderly, epileptic and those suffering from serious physical conditions are advised to avoid watching 3D images.
 - 3D pictures may startle viewers.
- * Please take care to be aware of the world around you. This product is designed to be immersive. Do not use this product near open stairwells, cables, balconies, or other objects that can be tripped over, run into, knocked down or fallen over. Being startled or deluding yourself into thinking that the 3D images are real may cause you to crush a nearby object or get injured when trying to move your body.
- * Children under the age of five are prohibited to watch 3D images or it will influence the children's vision.
- * If any of your relatives has a history of epileptic or strokes, please consult a medical specialist before using the 3D function.
- * You may not notice the 3D effect at all if you have a prescription for one eye that is very different from the other eye.
- * We recommend sitting with viewer's eyes on a level with the screen.
- * If your eyes show signs of fatigue or dryness or if you have any of the above symptoms, immediately discontinue use of this device and do not resume using it for at least thirty minutes after the symptoms have subsided.

Smart TV Function

3D Image

- When watching 3D Images, please wear 3D glasses.
- As the TV turns on, it may take seconds until the picture quality is optimized.
- The 3D passive glasses may not work properly if there is any other objects standing between the TV set and 3D glasses.
- Note that when your eyes are away and then back to the 3D Images, a short time will be needed for your eyes to get your eyes to re-adjust.
- When watching 2D Images, we recommend removing 3D glasses. If you wear 3D glasses to watch 2D Images, the picture will be distorted.

Safety information for watching 3D Images

You may not feel the 3D effect if your viewing angle and distance between the TV and glasses are out of range.

- 3D effect may not be available if the receiving area is out of range.
- Do not watch 3D pictures for a long period of time for your health.
- Note that watching TV with 3D glasses for an extended period of time may cause drowsiness and eye strain.
- If you experience any of the symptoms of headache, fatigue, dizziness, sickness, convulsions, loss of awareness, confusion, immediately stop watching 3D TV and consult a medical specialist.
- The pregnant, elderly, epileptic and those suffering from serious physical conditions are advised to avoid watching 3D Images.
- 3D pictures may startle viewers.
- Please take care to be aware of the world around you. This product is designed to be immersive. Do not use this product near open stairwells, cables, balconies, or other objects that can be tripped over, run into, knocked down or fallen over. Being startled or deluding yourself into thinking that the 3D Images are real may cause you to crush a nearby object or get injured when trying to move your body.
- Children under the age of five are prohibited to watch 3D Images or it will influence the children's vision.
- If any of your relatives has a history of epileptic or stroked, please consult a medical specialist before using the 3D function.
- You may not notice the 3D effect at all if you have prescription for one eye that is very different from the other eye.
- We recommend sitting with the viewer's eyes at the same level as the screen.
- If your eyes show signs of fatigue or dryness or if you have any of the above symptoms, immediately discontinue use of this device and do not resume using it for at least thirty minutes after the symptoms have subsided.

Attention for using 3D function

WARNING

- Wearing 3D glasses for any other purposes (as general spectacles, sunglasses, protective goggles, etc.) may physically harm you or weaken your eyesight.
- Do not put 3D glasses in extremely cold or overheated places.
- Do not use broken 3D glasses.
- Do not squeeze and strike the 3D glasses.
- Wipe the 3D glasses with clean and soft cloth.
- Do not use sharp objects or chemical products to wipe the surface of 3D glasses.

Smart TV Function

Range for Viewing 3D Images

TV sizes, viewing angle and other elements may make the viewing angel and distance different.

Viewing Distance	Viewing Angle
> 2.5m < 5m	100° (Viewing Distance : > 2.5m < 5m)

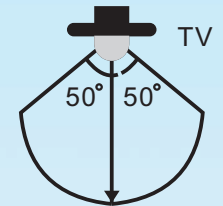

Please watch 3D Images within the effective distance and angle.

Recommendable Viewing Location (Up/Down)	Recommendable Viewing Location (Left/Right)
Up/Down: Center is recommended for inspection	Left/Right: $\pm 50^\circ$ degrees are recommendable

Watch 3D Pictures

You can go to MENU -> Picture -> 3D Settings. Or you can press 3D Button on the Remote Control to enter 3D settings. The window list will show such functions as below:

1. 3D Off: Turn the 3D function off.
 2. 3D Auto: Automatically identify 3D video under HDMI mode.
 3. 2D -> 3D: Change a 2D Image to 3D.
 4. 3D -> 2D: Change a 3D Image to 2D.
 5. 3D Effect adjustment: Adjust the 3D effect to your preference.
 6. Manual: You can choose Top Bottom or side by side to play 3D video.
- There are 2 methods for you to watch 3D Images.

Method 1:

1. Make sure the TV is under AV/ATV, YPbPr or VGA mode.
2. Wear 3D glasses and select a TV program.
3. Press MENU -> Picture -> 3D Settings. Or you can press 3D Button on the Remote Control to enter 3D Settings.
4. Press Up and Down Button to choose 2D >> 3D. Then press OK to confirm. 3D images will be shown on TV.
5. Should you exit the 3D Images, press 3D -> 2D under 3D Settings list.

Smart TV Function

Method 2

- 5.1 Make sure the TV is under Media mode.
- 5.2 Wear 3D glasses and select a program form Media.
- 5.3 Press MENU - > Picture - > 3D Settings , Or you can press 3D Button on the Remote Control to enter 3D Settings.
- 5.4 Press Up and Down to choose Manual, press OK to enter sub-menu. If the screen is under Side by Side mode, highlight Side by Side and press OK to confirm. Otherwise, press Top Bottom to confirm.
- 5.5 Should you exit the 3D Image, press "Side by Side to 2D or Top Bottom to 2D under 3D Manual Setting list.

Note: under HDMI mode, the system will automatically change into 3D Auto, you can choose 3D Effect Adjustment to make minor modulation of its 3D swap and view point. Exit by pressing 3D - > 2D

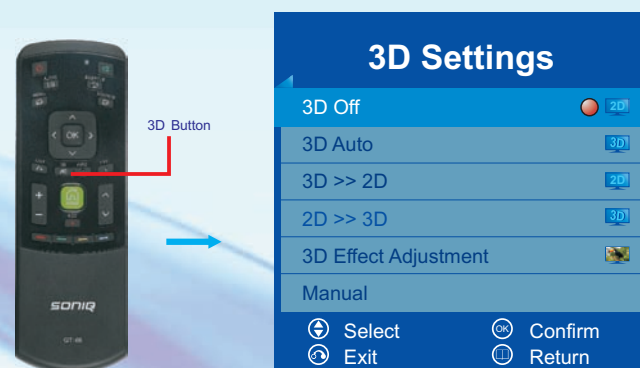

Specification

Supported 3D Signal Format

3D Interface	Signal	Resolution	Horizontal Frequency (KHZ)	Vertical Frequency (HZ)	Video Format
HDMI/MEDIA	720P	1280x720	89.1/90	59.94/60	Frame Packing
			75	50	Frame Packing
			44.955/45	59.94/60	Top and Bottom
			37.5	50	Top and Bottom
			44.955/45	59.94/60	Side and Side (half)
			37.5	50	Side and Side (half)
	1080i	1920x1080	33.72/33.75	59.94/60	Side and Side (half)
			28.125	50	Side and Side (half)
	1080P	1920x1080	53.946/54	23.976/24	Frame Packing
			67.432/67.5	29.97/30	Frame Packing
			26.973/27	23.976/24	Top and Bottom
			33.716/33.75	29.97/30	Top and Bottom
			67.432/67.5	59.94/60	Top and Bottom
			56.25	50	Top and Bottom
			26.973/27	23.976/24	Side and Side (half)
			67.432/67.5	59.94/60	Side and Side (half)
DTV	720P	1280x720	37.5	50	Side and Side (half)
	1080i	1920x1080	56.25	50	Side and Side (half)

Specification

Troubleshooting

Before calling a service center, attempt the following steps to diagnose the problem. TV unit.

Problem	Suggested Action
There is no power.	Ensure the power plug is securely inserted into the unit and wall outlet.
There is no picture or sound.	Try a different input source to check whether the source is at fault. Check for mis-connection of cables or for wrong input source.
There are spots on the screen.	Your unit is being affected by interference from automobiles, trains, high-voltage transmission lines, neon signs or another sources of interference. Try redirecting or relocating your antenna to reduce the affects of the interference.
Degraded colors or tints.	Check whether all the picture adjustments have been properly performed.
Improper Screen position or size.	Try selecting a different aspect ratio by pressing the <ASPECT> Button on the remote control.
The image appears distorted.	Ensure the display aspect ratio is correctedly set to suit the program source.
The image appears too bright, and there is a loss of definition in the brightest areas of the image.	Reduce the contrast settings. The AV video signal has not been terminated properly somewhere in the external AV equipment.
The image apperas too washed out, or the darkest areas of the image appear too bright.	Reduce the brightness level till the black areas of the picture appear as black.
Remote Control does not function properly.	Check for incorrect battery orientation. Check for dead batteries. Check your distance and angle from display. Check whether remote control is pointing at sensor window; Check for any obstacle between the Remote Control and Remote Control sensor. Check that the Remote Control sensor window is not under strong fluorescent lighting. Check for any devices (PC or personal digital assistant, PDA) nearby that transmit infrared signal which may cause interference to signal transmission between the Remote Control and the unit. Turn off the infrared function of these devices.
There is no picture or sound, just noise.	Make sure the antenna cable is properly connected. Change channels to confirm if the symptom is still present.
Picture is not clear.	Make sure the antenna cable is properly connected. Change channels to confirm if the symptom is still present. If PC (VGA) is selected as the input signal source, use the Auto Sync Function in the Set Up Menu (In VGA Mode) to let the display adjust picture automatically.
No sound.	Check whether you have selected the Mute function. Make sure the volume is not set to minimum. Check the AV cables for disconnection.

Specification

Antenna

Problem	Suggested Action
The picture is not sharp.	The reception may be weak. Change channels to confirm if the symptom is still present. Make sure the outside antenna is not disconnected. Make sure the antenna is facing the right direction.
The picture is doubled or tripled.	Make sure the antenna is facing the right direction. Picture ghosting is caused by reflections from buildings, large metal structures and mountains. Carefully realign your antenna to minimize the ghost images. Ultimately a higher quality antenna professionally installed may be necessary to reduce the ghosting.
The picture is spotted	There may be interference from automobiles, trains, high voltage lines, neon lights, etc. There may be interference between the antenna cable and power cable, try positioning them further apart.
There are stripes on the screen or colors fade.	Is the television receiving interference form other devices? Transmission antennas of radio broadcasting stations and transmission antennas of amateur radios and cellular phones may also cause interference. Use the television as far away as possible from devices that may cause possible interference.

Supported PC Input Signal

Your unit can use as PC monitor, it supports below.

RGB-PC, HDMI/DVI-PC mode INPUT SPEC				
PC/HDMI/1/2/3/4 input				
	Resolution	Horizontal Frequency (KHz)	Vertical Frequency (Hz)	Standard
INPUT FORMAT	640 X 480	31.5	60	VGA
	640 X 480	37.861	72.809	VESA
	640 X 480	37.5	75	VESA
	720 X 400	31.5	70	VGA-T
	800 X 600	37.9	60	VESA Guidelines
	800 X 600	48.077	72.19	VESA
	800 X 600	46.9	75	VESA
	832 X 624	49.7	75	Mac
	1024 X 768	48.4	60	VESA Guidelines
	1024 X 768	60	75	VESA
	1125 X 870	68.68	75	Mac
	1280 X 800	47.8	59.8	- - - -
	1280 X 960	60.0	60	VESA
	1360 X 768	47.7	60	VESA
	1280 X 1024	63.595	60	VESA
	1440 X 900	55.9	59.9	VESA
	1680 X 1050	65.3	60	- - - -
	1920 X 1080 (RGB-PC)	66.587	59.93	VESA
	1920 X 1080 (HDMI-PC)	67.5	60	VESA

Specification

Specification

Power Source	~100-240V AC, 50/60Hz		
Power Consumption	42" E42S14A	85W	
	47" E47S14A	100W	
	55" E55S14A	110W	
Video Format Supporting	COMPONENT	480i, 480p, 576i, 576p, 720p (50/60Hz) 1080i (50/60Hz), 1080p (50/60Hz)	
	HDMI	480p, 576p, 720p (50/60Hz), 1080i (50/60Hz), 1080 (50/60Hz).	
Analog TV	TV System	PAL B/G;D/K;I	
Digital TV	Programme Coverage	VHF-H 06 to 12 UHF 27 to 69	
	Video Decode	1080i ,720p ,576p,576i	
	Audio	MPEG,AC3	
Panel Spec	Effective Display Area	42" E42S14A	927.94mm x 521.96mm
		47" E47S14A	1039.68mm x 584.82mm
		55" E55S14A	1209.6mm x 680.4mm
	Panel Native Resolution	1920 x 1080 pixels	
	Brightness	350cd/m ² 130cd/m ² (3D)	
	Contrast Ratio	42" and 47" 1400 : 1, 55" 1300 : 1	
	Color Depth	8bit, 16.7 Million colors	
	Expectation of Life	around 50,000 hours	
Input/Output	ANT IN	ANT IN x 1	
	HDMI IN	HDMI X 4	
	USB IN	USB X 3	
	VGA IN	VGA X 1	
	VGA VIDEO IN	VGA AUDIO X 1	
	VIDEO IN	VIDEO X 2	
	Digital Audio Out (Optical)	Digital Audio Optical Out x 1	
	LAN	RJ45 x 1	
	SD CARD	SD CARD SOCKET X 1	
	AV Out	VIDEO X 1	
Audio Power	6W + 6W		
Unit Dimension (including the size of the base)	42" E42S14A	954(L) ★ 255(W) ★ 621 (H)mm	
	47" E47S14A	1067(L) ★ 255(W) ★ 693 (H)mm	
	55" E55S14A	1238(L) ★ 255(W) ★ 790 (H)mm	
Wireless LAN Specification	Standard	IEEE802.11 802.11b/g/n	
	Frequency Band	2.4~2.4835 GHz ISM Band 3	
	Output Power	<13dBm@11n, <18dBm@11b,<14dBm@11g	